

Detailed botanical illustrations of various flowers, including what appears to be a daisy-like flower at the top and several large, multi-petaled flowers with prominent centers, are positioned in the corners of the page. The background is a light, textured pattern of fine lines.

# *Florescence*

---

## ILLUSIONS

A GARDEN CLUB OF AMERICA  
MAJOR FLOWER SHOW  
PRESENTED BY  
RIVER OAKS GARDEN CLUB  
THE GARDEN CLUB OF HOUSTON  
AND  
THE MUSEUM OF FINE ARTS, HOUSTON

11TH BIENNIAL

APRIL 28–29, 2015

SCHEDULE

[flohouston.org](http://flohouston.org)



River Oaks Garden Club  
The Garden Club of Houston  
Members of The Garden Club of America  
and  
The Museum of Fine Arts, Houston

Present

# *Florescence*

---

ILLUSIONS

11th Biennial

A Garden Club of America Major Flower Show

April 28–29, 2015

The Museum of Fine Arts, Houston  
Audrey Jones Beck Building  
5601 Main Street

Open to the Public

Tuesday, April 28, and Wednesday, April 29, 2015  
10:00 a.m.–5:00 p.m.

Museum members free; general admission \$15

For the most current information, please go to our website  
[flohouston.org](http://flohouston.org)

We do not need magic to transform our world.

We carry all the power we need inside ourselves already.

We have the power to imagine better.

—*J. K. Rowling, British fantasy author, Harvard University Commencement Address, 2008*

# *Florescence*

## ILLUSIONS

### TABLE OF CONTENTS

	Page
Timetable for Exhibitors .....	4
Florescence Committee .....	6
Museum Rules .....	11
GCA General Rules and General Information .....	12
<b>Division I: Floral Design</b> <i>Creative Essence</i>	
Floral Design Guidelines .....	14
Floral Design Classes .....	15
<b>Division II A: Horticulture</b> <i>Verdant Reverie</i>	
Horticulture Guidelines .....	17
Horticulture Classes .....	19
<b>Division II B: Horticulture Design</b> <i>Fantasia</i>	
Horticulture Design Guidelines .....	22
Horticulture Design Classes .....	24
<b>Division III: Photography</b> <i>Imagined Images</i>	
Photography Guidelines .....	25
Photography Classes .....	27
<b>Division IV A–C: Botanical Arts</b> <i>Charmed</i>	
Botanical Arts Guidelines .....	28
Botanical Arts Classes .....	29
<b>Division IV D: Needle Arts</b> <i>Sleight of Hand</i>	
Needle Arts Guidelines .....	30
Needle Arts Classes .....	31
<b>Division V: Conservation</b> <i>In Praise of Pollinators: Unlocking the Magic and Mystery</i> .....	32
<b>Division VI: Art by Invitation</b> <i>Fantasy Friends</i> .....	33
GCA Major Flower Show Awards and Florescence Awards .....	34
Maps and Directions .....	36

## TIMETABLE FOR EXHIBITORS

Monday, April 28, 2014	Horticulture—one-year ownership deadline
Monday, July 28, 2014	Horticulture—nine-month ownership deadline
Friday, August 1, 2014	Needle Arts registration opens
Monday, September 1, 2014	All Divisions registration opens except Needle Arts and Photography
Tuesday, October 28, 2014	Horticulture—six-month ownership deadline
Saturday, November 1, 2014	Needle Arts registration deadline
Thursday, January 1, 2015	Photography registration opens
Wednesday, January 28, 2015	Horticulture three-month ownership deadline
Saturday, January 31, 2015	Floral Design registration deadline Horticulture Design registration deadline Photography digital image due Botanical Arts registration deadline
Monday, February 2, 2015	Needle Arts finished canvas delivery deadline
Wednesday, February 25, 2015	Notification of Photography Jury results
Wednesday, March 25, 2015	Photography delivery deadline
Wednesday, April 1, 2015	Plant list deadline for Floral Design entries
Monday, April 6, 2015	Botanical Arts delivery deadline
Monday, April 27, 2015	<p><b>Floral Design Exhibitors</b>            1:00–5:00 p.m. Delivery of containers and flowers to Beck Building            (Main Street porte cochere entrance)            1:00–5:00 p.m. Arranging in Beck Galleries            3:00–5:00 p.m. Passing in Beck Galleries</p> <p><b>Horticulture Exhibitors</b>            1:00–5:00 p.m. Cut specimens and all container grown plants entry/passing in            the MFAH Parking Garage and Visitor Center (enter from Binz Street)</p> <p><b>Horticulture Design Exhibitors</b>            1:00–5:00 p.m. Plant Inspection in the MFAH Parking Garage and Visitor Center            (enter from Binz Street)            1:00–5:00 p.m. Entry/passing in place</p>

---

Tuesday, April 28, 2015

**Floral Design Exhibitors**

6:30–9:00 a.m. Challenge Class arranging/passing in Beck Building galleries

6:30–9:00 a.m. Continued arranging/passing in Beck Building galleries

9:00 a.m. All Floral Design passing closes

**Horticulture Exhibitors**

6:30–9:00 a.m. Cut specimen entry/passing in the MFAH Parking Garage and Visitor Center  
(enter from Binz Street)

(container plant entry for out-of-town exhibitors only)

**All Divisions**

9:00 a.m. All Division entries close

**Judges**

9:30 a.m. Judges briefing; clerks briefing

10:00 a.m.–12:00 p.m. Judging begins for all Divisions

12:30–1:30 p.m. Judges Luncheon and Flower Show evaluation

10:00 a.m. MFAH opens to public

**Floral Fête**

*Presenter: Emily Thompson*

2:30 p.m. Brown Auditorium, Caroline Wiess Law Building, MFAH

Reception to follow

Reservation required\*

**Enchanted Evening**

Cocktail reception and show viewing

7:00 p.m. Beck Building

Reservation required\*

---

Wednesday, April 29, 2015

8:00–9:30 a.m. Refreshing and maintenance of exhibits by Preservation Committee

10:00 a.m. MFAH opens to public

***Illusions Luncheon and Lecture***

*Presenter: Luciano Giubbilei*

11:00 a.m. Program Begins: Caroline Wiess Law Building, MFAH

Luncheon to follow: Caroline Wiess Law Building, MFAH

Reservation required\*

6:00 p.m. Show closes

6:15–7:00 p.m. All entries removed, and horticulture cut specimens discarded

\*Tickets to events are limited. Individual tickets to go on sale Tuesday, January 20, 2015.

To purchase tickets, call Development Special Events at 713-639-7523.

Tickets are reserved on a first-come, first-served basis.

## FLOWER SHOW COMMITTEE

POSITION	RIVER OAKS GARDEN CLUB	THE GARDEN CLUB OF HOUSTON
Show Chairmen	Kelty Crain keltycrain@gmail.com 713-562-8808	Debbie Robinson debbiedrobinson@comcast.net 281-414-4959
Show Assistants	Betty Newton bettynewton713@gmail.com 713-302-6957	Nancy Keely Nancydaviskeely@Mac.com 713-201-6281
<b>Division I: Floral Design</b>		
Chairmen	Stephanie Fox xofsteph@gmail.com 713-523-1485	Marianna Brewster brewsbag@aol.com 713-515-2939
Assistant Chairmen	Donna Maddox dmm6115@aol.com 713-569-7585	Renee Davis rdominguedavis@hotmail.com 832-215-5766
Challenge Class	Georga Harrison georgaharrison@gmail.com 713-298-1080	Jenny Kempner jbkemp@hal-pc.org 713-253-4031
Challenge Assistants	Jane Howe janewhowe@gmail.com 713-557-3175	Mundi Elam Mselam96@hotmail.com 713-703-4331
Container Return	Vicki Woodson vicki@petitealma.com 713-503-0035	Teresa Elsom tbelsom@mac.com 713-823-3977
Assistant	Sandra McBride slmcbride@swbell.net 713-963-0606	Mathilde Hoefler mathildeh@johndaugherty.com 713-492-1511
Passing	Adele Spalding adelespalding@sbcglobal.net 713-594-8462	Liz Wozencraft lizwoz@att.net 713-252-3720
Runners	Carolyn Utt uttcrs@aol.com 713-857-3071	Gail Orr gailworr@yahoo.com 713-256-4896
<b>Division II: Horticulture</b>		
Chairmen	Tara Eastland tgeastland@aol.com 281-639-9516	Dodie Jackson dodieojackson@gmail.com 713-299-2694
Passing Chairmen	Collier Blades crbwm@aol.com 713-560-5285	Katherine Galloway khgalloway@comcast.net 713-899-5735



POSITION	RIVER OAKS GARDEN CLUB	THE GARDEN CLUB OF HOUSTON
Passing Committee		
Bottles	Melinda Abell	Jackie Wallace/Vivie O'Sullivan
Plant ID	Kay Rice	Alice Thomas
Grooming	Cheri Fossler	Liz Rotan
Bugs	Jeannie Sanders	Susan Reedy
Consultants	Chris Caudill clc3245@aol.com 713-628-1134	Susan Lummis stlummis@gmail.com 713-516-3412
Runners	Clare Smith cbearoo82@gmail.com 713-503-7539	Ellen Donnelly ellendonnelly@att.net 281-450-5212
Registration/Entry Books	Chris Caudill clc3245@aol.com 713-628-1134	Sally Meadows sallykmeadows@gmail.com 713-299-2520
Placement	Kackie Dunwoody kackied@yahoo.com 713-725-2386	Emily Wilde Emilyswilde51@gmail.com 713-857-6273
Assistant	Bitsey Hail behail@comcast.net 713-254-8454	Ardon Armstrong ardonarm@yahoo.com 713-553-9471
<b>Division II B: Horticulture Design</b>		
Chairmen	Vaughan Clark vaughanc1@aol.com 713-963-0903	Kingslea Von Helms Kt1648@aol.com 713-899-2128
<b>Division III: Photography</b>		
Chairmen	Ray Chilton ray1112@aol.com 281-788-8544	Pat Gano patgano@hotmail.com 832-452-1020
Assistant Chairmen	Carol Junell carol@junell.cc 713-467-0241  Anne Symonds aasymonds@gmail.com 713-520-0770	Fran Brennan mfranbrennan@aol.com 713-416-9585  Cindy Fitch cbfitch@gmail.com 713-653-4254
<b>Division IV A-C: Botanical Arts</b>		
Chairmen	Lynn Wilson lmw2710@yahoo.com 713-478-4114	Francey Pengra fpengra@earthlink.net 713-248-8822
<b>Division IV D: Needle Arts</b>		
Chairmen	Betsy Garibaldi betsy.garibaldi@gmail.com 713-927-4666	Anne Hawkins aehawkmath@aol.com 713-253-6339

POSITION	RIVER OAKS GARDEN CLUB	THE GARDEN CLUB OF HOUSTON
<b>Division V: Conservation</b>		
Chairmen	Helen Chambers helenchambers@mindspring.com 713-906-6595	Margaret Pierce Mpierce446@aol.com 713-661-6422
Assistant Conservation	Patty Shepherd patty.shepherd@att.net 281-787-3773	Adele Bentsen adelebentsen@me.com 713-819-7821
<b>Division VI: Art by Invitation</b>		
Chairmen	Mary Jane Wakefield mjw715@aol.com 713-550-4862	Betsy Griffin bgriffin@griffinpartners.com 713-622-3588
<b>All-Show Chairmen</b>		
Clerks	Anne Suman namus1215@gmail.com 713-206-5123	Ingrid Kelly Ingridkelly@att.net 713-502-8165
Hostesses	Callie Paterson chpaterson@aol.com 713-854-7987	Anne Frischkorn Keasbey1@aol.com 713-254-2141
Information Desk	Jane Bonham jane.bonham@gmail.com 713-305-8691	Kathy Arcidiacono karcidiacono@greenwoodking.com 713-822-1749
Judges	Carole Bailey cbaileybmt@aol.com 713-392-1681	Jeanie Carter Jcarter22@earthlink.net 713-447-6003
Judges Hospitality	Kit Detering kit.detering@gmail.com 713-817-0676	Verlinde Doubleday vhdoubleday@gmail.com 281-813-3681
	Carmen Knapp sailby2@aol.com 713-203-1040	
Judges Transportation	Charner Bolin charnerb@hotmail.com 713-822-8862	Laura Kelsey lhkelsey@me.com 713-503-1833
	Amanda Hellmann amandahellmann@aol.com 713-253-6534	
Luncheon	Marjorie Cain marjoriecain@sbcglobal.net 713-498-0112	Mary Smith marystantonsmith@mac.com 713-819-4110
	Mary Gregory mrmgregory@comcast.net 713-894-9644	Vivie O'Sullivan vivieos@yahoo.com 713-298-2250

POSITION	RIVER OAKS GARDEN CLUB	THE GARDEN CLUB OF HOUSTON
Nametags	Robin Wombwell robinwombwell@aol.com 281-686-2214	Alison Tennant awt2527@aol.com 713-850-1000
Opening Reception	Nancy Abendshein nancyabend@me.com 713-249-1855	Julie Griffin juliepgriffin@comcast.net 713-202-7175
	Rosanna Blalock rdblalock@msn.com 713-851-3405	Cindy Wallace dcrrwallace@sbcglobal.net 713-540-6962
Photographer	Phoebe Muzzy pwmuzzy@gmail.com 713-621-1249	
Preservation	Sarah Eilers sbeilers@gmail.com 713-875-6756	Grace Pierce Gracepierce500@gmail.com 713-498-5831
	Sandy Lucas sdlucas@lucaseilers.com 713-249-0045	Carla Ohls cohls@hotmail.com 281-687-0985
Provisionals	Patti Broussard pattibrou919@yahoo.com 713-962-5651	Margaret Rotan mwrotan@comcast.net 713-202-3856
	Wendy Chiles wendynut@aol.com 713-248-8204	
Publicity	Cathy Cleary cfitz28@hotmail.com 713-503-2053	Clayton Erikson cgerikson@me.com 713-419-2161
Show Consultant		Gay Estes txestes@aol.com 713-249-9047
Signage	Lisa Stone lisa@crosswell.net 713-870-1211	Laura Rowe Crawford laurarowecrawford@gmail.com 832-866-9474
Staging	Allison Bailey allisonbailey13@gmail.com 713-898-1911	Susannah Wallace susannahwallace@comcast.net 713-392-6626
Assistant Staging	Susie McGee sueqinhou@aol.com 713-542-1508	Catherine Randall caterandall@sbcglobal.net 713-515-3351
Floral Fête	Leslie Sasser leslie@lelkinsarch.com 713-253-7307	Cathy Chapman cathy@chapmandesigninc.net 832-643-2121

POSITION	RIVER OAKS GARDEN CLUB	THE GARDEN CLUB OF HOUSTON
Technical Liaison		Melinda Nickens mhnickens@aol.com 713-818-3661
Computer/Entry	Cynthia Lange cynthia.lange@me.com 713-899-6287	Karen Ytterberg kytterberg@aol.com 713-569-2148
Awards, Special	Anne French afrench454@aol.com 713-515-6622	Sara Ledbetter sara@ledbetterhome.net 713-854-5555
	Vicki Lange vvlange@comcast.net 832-452-7785	Robin Howell rohowell7@comcast.net 713-725-3041
Registration	Susan Doherty dohertysr@gmail.com 713-975-7899	Janet Lionberger janetlion@gmail.com 832-594-7801
Treasurer		Sally Giammalva ssgiammalva@comcast.net 713-252-8870
Underwriting	Liz Rigney Lrigney957@gmail.com 713-805-1923	Chris Athon chrisathon@gmail.com 713-703-6963
Underwriting Assistants	Jennifer Bowen jenniferbowen60@gmail.com 713-302-5406	Lester Grundy lgrundy@comcast.net 281-300-2348
Volunteer Hospitality	Maudie Beard beardexpl@aol.com 713-829-9714	Susan Horne Shorne6127@att.net 713-444-0050
Club Presidents	Terry Smith terrypeith1@gmail.com 713-906-4641	Susan Miclette smiclette@comcast.net 713-854-3700

## MUSEUM RULES

The protection and preservation of the art is the top priority of the Museum of Fine Arts, Houston (MFAH). The following rules regarding all Florescence entries will be strictly enforced at all times. Failure to comply with these rules may result in disqualification and removal of an exhibit.

### 1. Safe Distance from Art Must Be Maintained

Pedestals, tables, and risers may not be moved or repositioned as they are all carefully placed by MFAH staff.

In addition, classes with dimension limits will be closely monitored for compliance.

### 2. Misting of Exhibits Is Prohibited

Exhibitors may not mist any material, including any material for Floral Design (whether a completed arrangement or backup material in buckets or boxes) or any material for Horticulture (whether container grown, a cut specimen, or a completed Horticulture Design).

The only exception to this rule is the official Florescence Preservation Committee. The Committee will monitor

the condition of entries overnight and maintain all in pristine condition. Only the Preservation Committee may mist or top off water for any exhibit under MFAH staff supervision.

### 3. Use of Paints and Glues Is Prohibited in the MFAH

Paint, shellac, mastic, adhesive, glue, or any other such material, whether aerosol spray, non-aerosol spray, bottle, jar, or can are not permitted inside the MFAH. Glue guns, paint pens, and glitter pens are not permitted inside the MFAH.

### 4. Flash Photography Is Prohibited in the MFAH

Exhibitors may not use flash photography in the MFAH. Only the official Florescence photographers may use flash cameras.

Please help the MFAH ensure the safety of its collection for the generations to come. We are all stewards in the preservation of our cultural heritage.

---

### The Museum of Fine Arts, Houston

Gary Tinterow, *Director*

Helga Aurisch, *Curator, European Art*

Julie Bakke, *Chief Registrar*

Shemon Bar-Tal, *Chief Technology Officer*

Dale Benson, *Chief Preparator*

Edgar Peters Bowron, *The Audrey Jones Beck Curator of European Art*

Bart Brechter, *Curator, Bayou Bend Gardens*

Graciela Constanza, *Senior Graphic Designer*

James Clifton, *Curator, Renaissance and Baroque Painting*

Malcom Daniel, *Curator in Charge—Department of Photography and Special Projects*

Ashley Dillard, *Deputy Chief Development Officer, Special Events*

Jack Eby, *Chief Exhibition Designer*

Alison de Lima Greene, *Curator, Contemporary Art and Special Projects*

Linda Kuykendall, *General Manager of Special Events*

Christine Manca, *Senior Editor*

Frances Marzio, *Curator, The Glassell Collections, African, Oceanic, the Americas, and Antiquities*

Yasufumi Nakamori, *Associate Curator, Photography*

Amy Purvis, *Chief Development Officer*

Mari Carmen Ramírez, *The Wortham Curator of Latin American Art and Director, International Center for the Arts of the Americas*

Deborah Roldán, *Assistant Director, Exhibitions*

Cindi Strauss, *Assistant Director, Programming and Curator, Modern and Contemporary Decorative Arts and Design*

Anne Wilkes Tucker, *The Gus and Lyndall Wortham Curator of Photography*

Karen Vetter, *Chief Administrator for Curatorial Affairs*

Kaylin Weber, *Assistant Curator, American Painting and Sculpture*

Dena Woodall, *Associate Curator, Prints and Drawings*

## GCA RULES AND GENERAL INFORMATION

1. Please carefully read and follow GCA flower show rules, general information, and division guidelines. All rules as stated in *The Garden Club of America Flower Show and Judging Guide*, July 2014 Revised Edition, shall apply.
8. A statement of intent is optional except as noted in the schedule and must be submitted at the time of passing. The statement must be no more than 25 words, typed or printed in waterproof ink on a 4" x 6", white, unlined card.

### SAFETY

2. The Garden Club of America, River Oaks Garden Club, The Garden Club of Houston, and the Museum of Fine Arts, Houston, will exercise due caution in safeguarding exhibits but assume no responsibility for damage, loss, or personal injury before, during, or after the show.
3. Entrance to the MFAH will be limited during staging and entry times. Nametags will be required for entrance and timelines will be strictly enforced.
9. The Passing Committee must pass each entry before an exhibitor may leave the show area. The Passing Committee reserves the right to refuse any entry that does not conform to the schedule. The exhibitor(s) has the option of correcting the entry, if time permits. If not corrected, the entry cannot be judged, but may remain in place, marked "For Exhibit Only." The judges may not disqualify any entry passed by the Passing Committee, unless evidence of insect infestation or disease is identified.

### ENTRIES AND PASSING PROCESS

4. Any clarification or change in the rules as originally stated in the schedule will be communicated promptly in writing by the Division Chairmen to all exhibitors in the class, and at the show, to the Passing Committees and the judges.
5. Registration for Divisions I, II B, III, IV A–C, IV D, V, and VI is required. Registration is online only, by going to [flohouston.org](http://flohouston.org). Classes will be filled in the order registration forms are electronically received. Confirmation of registration will be sent to entrants by e-mail. Direct any questions to the Registration Chairmen, Susan Doherty, [dohertysr@gmail.com](mailto:dohertysr@gmail.com), or Janet Lionberger, [janetlion@gmail.com](mailto:janetlion@gmail.com).
6. Entries are open to all GCA club members, including provisional members, and professionals in their disciplines, and by invitation.
7. An entry card must accompany each entry. Entry cards will be available at the show and upon request from the entry or division chairmen, in advance of the show. Information required on the entry card must be completed in black waterproof medium.
10. Once an entry is passed, the exhibitor(s) must immediately leave the show floor. The only exception will be flower show committee members who have entered and been passed according to the timetable. A passed entry may not be touched again until after judging and then only to carry out necessary maintenance.
11. At no time may exhibitors touch any exhibits other than their own.
12. All containers and accessories must be inconspicuously labeled with the exhibitor's name(s).

### PLANT MATERIAL

13. All plant material must be correctly identified with the botanical and common names on the entry card, except where indicated in the schedule. Accepted references for nomenclature are: *AHS A–Z Encyclopedia of Garden Plants*; The Plant List at [www.theplantlist.org](http://www.theplantlist.org); International Plant Names Index at [www.ipni.org](http://www.ipni.org) or <http://www.internationalplantnames.com>; Plant Systematics at [www.plantsystematics.org](http://www.plantsystematics.org); and Royal Horticultural Society Plant Finder Data Base at <http://apps.rhs.org.uk/rhsplantfinder>.

14. The Garden Club of America expects all exhibitors to be aware of the need to promote conservation of endangered and threatened plants. Plants collected in the wild and listed by the Texas Natural Heritage Program may not be exhibited in any flower show sponsored by a GCA club. Cultivated plant material listed by Texas Natural Heritage Program may be exhibited only if accompanied by a typed card stating that it has not been collected from the wild and giving information concerning its cultural requirements and methods of propagation. Natural Heritage Programs' list of endangered plant material will be available before and during the show from the Division Chairmen, and is available online at [plants.usda.gov/threat.html](http://plants.usda.gov/threat.html).

15. Plant material showing evidence of insects or disease must be removed immediately from the exhibition area. This rule will be enforced at any time during the show, whenever the problem is identified.

16. All entries in the Floral Design and Horticulture Divisions must include fresh and/or dried plant material. Fresh plant material must be in water or conditioned in such a way as to remain in pristine form while on exhibition. An entry not maintained in show condition may have its award removed. Entries in Photography are not required to include plant material unless stated in the class description. Entries in Botanical Arts Division must use dried plant material or as stated in the class description.

17. Locally invasive plants, diseased plant material, artificial plant material, live animals (including fish), taxidermy, natural birds' nests, and protected sea life are not permitted; see [plants.usda.gov/java/noxiousDriver](http://plants.usda.gov/java/noxiousDriver).

## JUDGING

18. Only participating judges and clerks will be allowed on the show floor during judging. Flower Show Chairmen and Division Chairmen should remain nearby but off the show floor until needed.

19. A novice is an exhibitor who has not won a first place ribbon or a GCA Special Award, in the division entered at a GCA Major Flower Show or Sanctioned Non-GCA Major Flower Show. Only an individual novice exhibitor is eligible to receive the GCA Novice Award or the Sandra Baylor Novice Floral Design Award. A novice exhibitor will be identified on the entry card following the initial judging.

## REMOVAL

20. All exhibits must remain in place and in show condition until 15 minutes after the show's closing time. Exhibitors must remove exhibits on Wednesday, April 29, 6:15–7:00 p.m., with the exception of Photography, which **MUST** be removed by Museum staff and will be available for pick up on Thursday at location to be announced.

For an additional charge, an out-of-town exhibitor's entry may be returned by a shipping service. Please go to [flohouston.org](http://flohouston.org) for information.

# Division I: Floral Design

## *Creative Essence*

### Guidelines

1. Please carefully read and follow the GCA Rules and General Information and Timetable for Exhibitors.

#### ENTRIES

2. An exhibitor is permitted only one entry per class, but may enter more than one class. An exhibitor may have one partner per entry except Classes 4, 8, and 9, where only individual exhibitors are permitted. The exhibitor(s) under whose name(s) the entry has been registered must create and complete the design. All participants must be listed. Only listed exhibitors and show personnel may be on the show floor at the time of entry.
3. If forced to withdraw, an exhibitor must notify the Registration Chairmen, the Division Chairmen, and the class consultant and must find a substitute unless there is a waiting list for the class.

#### FLORAL DESIGN REQUIREMENTS

4. All pedestals and niches are painted Benjamin Moore Super White. Pedestals may not be moved. Tops of pedestals may not be enlarged or draped.
5. Cut fruits/vegetables or foods of any kind are not permitted.
6. Mechanics should not be visible unless they are an integral part of the design.
7. Accessories are permitted, unless otherwise stated in the class description.
8. All designs must be executed at the show. However, complex components requiring extensive time for construction may be prefabricated and then assembled at the show.
9. Anything not prohibited in the Museum Rules, GCA Rules, Floral Design Division Guidelines, or individual class descriptions is permitted.

#### REGISTRATION INFORMATION AND DEADLINES

10. Registration is **online only**, and is required between Monday, September 1, 2014, and Saturday, January 31, 2015, by registering online at [flohouston.org](http://flohouston.org). For any questions regarding registration, please contact one of the Registration Chairmen, Susan Doherty, [dohertysr@gmail.com](mailto:dohertysr@gmail.com), or Janet Lionberger, [janetlion@gmail.com](mailto:janetlion@gmail.com).

11. For classes interpreting works of art in the Museum, color reproductions of the artwork will be online at [flohouston.org](http://flohouston.org). It is possible the colors will not match the actual colors of the piece of art perfectly and the judges will be made aware of this.
12. Museum collections are subject to change. If this occurs, exhibitors will be notified as soon as possible by the Flower Show Committee.
13. Plant list with common and botanical names along with optional brief statement of intent, 25 words or less, is due to the Computer Entry Chairmen, Karen Ytterberg, [kytterberg@aol.com](mailto:kytterberg@aol.com), or Cynthia Lange, [cynthia.lange@me.com](mailto:cynthia.lange@me.com), by Wednesday, April 1, 2015, by using the entry form online at [flohouston.org](http://flohouston.org). Changes may be made at the show.
14. Challenge Classes 8 and 9 are open to individual out-of-town exhibitors only and the required fee of \$75.00 must be paid at time of registration.

#### JUDGING

15. Judging will be based on the principles of design: balance, contrast, dominance, proportion, rhythm, and scale; and the elements of design: light, space, line, form, color, texture, pattern, and size. Creativity is important, as is distinction, conformance, and interpretation of the class and schedule. For the scale of points for Floral Design, please refer to the GCA Flower Show and Judging Guide Chapter V, Section VIII, or follow the link on our website, [flohouston.org](http://flohouston.org).

#### REMOVAL

16. Wednesday, April 29, 6:15–7:00 p.m., all entries removed. For an additional charge, an out-of-town exhibitor's entry may be returned by a shipping service. Please go to [flohouston.org](http://flohouston.org) for information.

#### INQUIRIES

By e-mail at any time.  
By telephone weekdays, 9:00 a.m.–5:00 p.m.  
Central Time.

**Stephanie Fox**  
[xofsteph@gmail.com](mailto:xofsteph@gmail.com)  
713-523-1485

**Marianna Brewster**  
[brewsbag@aol.com](mailto:brewsbag@aol.com)  
713-515-2939



# Division I: Floral Design

## *Creative Essence*

### Classes

#### Class 1. Mystic West

4 Entries

Designs inspired by the museum's permanent collection of Frederic Remington paintings; staged on a 40" x 15½" square pedestal. Design may not exceed 20" from the center of the pedestal and 8' in overall height from floor; Gallery height is 14'; Gallery wall color is a custom mixed burgundy red; Viewed from three sides.

- a. *Aiding a Comrade*, Frederic Remington, 1889–90, 34⅞" x 48⅞"
- b. *The Mier Expedition: The Drawing of the Black Bean (Prisoners Drawing Their Beans)*, Frederic Remington, 1896, 27⅞" x 40"
- c. *The Call for Help*, Frederic Remington, c. 1908, 27¼" x 40⅞"
- d. *Episode of the Buffalo Gun*, Frederic Remington, 1909, 27⅞" x 40¼"

Location: Beck Building, Kilroy Foundation Gallery, Gallery 107, First Floor

#### Class 2. Virtual Reality

Up to 6 Entries

Designs inspired by the museum's permanent collection of North American Arts, staged on a 40" x 15.5" square pedestal. Design may not exceed 20" from center of pedestal and 8' in overall height from floor. Gallery height is 14'; gallery wall color is custom mixed beige. Viewed from three sides.

- a. *Vase*, Louis Comfort Tiffany, c. 1892–93, 21½" x 8⅞" x 8⅞"
- b. *The Japanese Book*, William Merritt Chase, c. 1900, 72½" x 36½"
- c. *Arm Organization*, Stanton Macdonald-Wright, 1914, 36" x 30⅞"
- d. *Tango*, Elie Nadelman, c. 1918–24, Male figure: 33½" x 17½" x 13¼", Female figure: 34¼" x 17½" x 11¼"
- e. *Peinture/Nature Morte*, Patrick Henry Bruce, c. 1920–1921, 35" x 46"
- f. *Children in the Garden (The Nurse)*, Mary Cassatt, 1878, 25¼" x 31⅞"

Location: Beck Building, Hevrdejs Gallery South, Gallery 108, First Floor

#### Class 3. Lightness of Being

Up to 6 Entries

Designs inspired by Alexander Calder's mobile, *International Mobile*; staged on a 40" x 15½" square pedestal. Design may not exceed 20" from center of pedestal and 8' in overall height from floor. Gallery height is 25'; gallery wall color is Benjamin Moore 1464 Light Pewter. Viewed from three sides.

Location: Beck Building, Long-Sarofim Gallery, Gallery 109, First Floor

#### Class 4. Masters of Deception

Up to 6 Entries

A design using trickery, chicanery, wiliness, guile, intrigue, subterfuge and/or artifice! Staged on a 40" x 15½" pedestal. Design may not exceed 20" from center of pedestal and no height restriction. Gallery wall color is cast stone. An invitational class. Viewed from all sides.

Location: Beck Building, Cullen Foundation Atrium, Gallery 104, First Floor

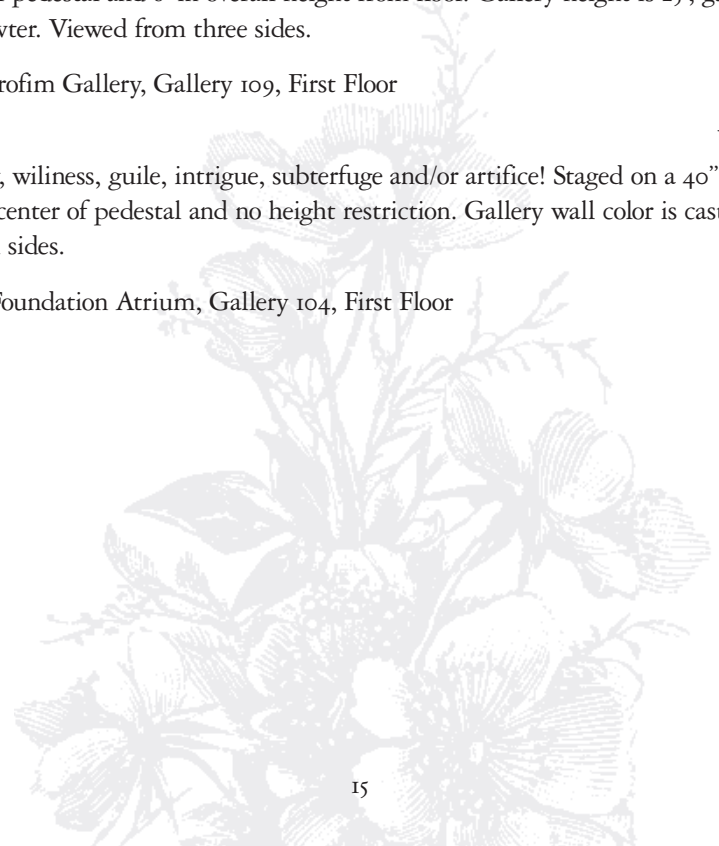

**Class 5. Altered States**

**Up to 6 Entries**

A synergistic design of 3 or more units creating a complete unified whole. Staged on 2 touching square pedestals; measuring 40" x 14" and 34" x 14". Design may not exceed 6" from edge of pedestal and 8' in overall height from floor. Gallery height is 15'; gallery wall color is Benjamin Moore 985 Indian River. Viewed from three sides.

Location: Beck Building, Gallery 207, Second Floor

**Class 6. Faces of Janus**

**Up to 6 Entries**

A two-sided design, having two distinct sides, which cannot be seen from the opposite side. Staged on a 40" x 14" white square pedestal. Design may not exceed 20" from center of pedestal and 8' in overall height; Gallery height is 15'; gallery wall color is Benjamin Moore 985 Indian River; Viewed from all sides.

Location: Beck Building, Gallery 207, Second Floor

**Class 7. Through the Looking Glass**

**Up to 6 Entries**

A design in a white niche 24" x 16½" x 14¼" staged at 46". Viewed from front only.

Location: Beck Building, Gallery 222, Second Floor

**Class 8. Over the Rainbow**

**4 Entries**

A Challenge Class for out-of-town exhibitors. Fee required.

Location: Beck Building, Gallery 203, Second Floor

**Class 9. Emerald City**

**4 Entries**

A challenge class for out-of-town exhibitors. Fee required.

Location: Beck Building, Gallery 203, Second Floor

**Class 10-A Enchanted Portal**

**5 Entries**

**Class 10-B Enchanted Portal**

**5 Entries**

A small door replica, 20" high by 11' wide, to be adorned with a design to represent what lies beyond. Door replicas and support bases will be provided and may be decorated in advance. A novice class limited to and required of all Provisional members of River Oaks Garden Club (first year only) and The Garden Club of Houston. Viewed from front.

Location: Beck Building, Millennium Gallery, Lower Level



# Division II A: Horticulture

## *Verdant Reverie*

### Guidelines

1. Please carefully read and follow the GCA Rules and General Information and Timetable for Exhibitors.

#### ENTRIES

2. Entries must have been owned and grown by the exhibitor for a minimum of six months (October 28, 2014). Exceptions are as follows: 1. Class 30, Vegetable, has a three-month ownership (January 28, 2015), 2. Classes 37–40, Topiary, Classes 41–48, Cacti and Succulents, and Class 50, Orchids, have one year ownership (April 28, 2014).
3. An exhibitor may submit up to three entries per class, provided each is a different species or cultivar.

#### PLANT/SPECIMEN REQUIREMENTS

4. With the exception of Classes 34–36, Cut Collection, the maximum length of an entered cut specimen is 26" measured from the lip of the container to the end of the vine, branch, or leaf.
5. All cut specimens must be in show condition at the time of judging. Wilted specimens are subject to removal by the Horticulture Committee.

#### DISPLAY/CONTAINER REQUIREMENTS

6. Leaf polish or other commercial foliage enhancers are not permitted.
7. Container and wedging material will be provided for all cut specimens.
8. Containers may not exceed a 12" inside dimension measured on the interior diagonal. Exceptions apply to Classes 66–67 which will be displayed in window boxes. Class 37, Topiary in Asian Manner, and Class 68, Par, have no container restrictions.
9. Container grown plants should be exhibited in containers that are clean, unobtrusive and compatible with the exhibit. Terracotta pots are preferred. Other options include terracotta colored pots. Asian Manner containers, Class 37 allows Asian Manner containers. Class 64 allows natural containers such as driftwood, rock, stone or shell. Classes 66–67 will be exhibited in window boxes.
10. Double potting is permitted, provided natural top dressing is used and the inside container is not visible. Top dressing must not float when watered. Therefore, sphagnum moss and Spanish moss are not permitted as a top dressing.

11. To designate a preferred exhibiting side, exhibitors must mark the center back of the container with a white chalk mark.
12. If an entry (such as a forced bulb or orchid) is staked, the support must be as unobtrusive as possible.

#### REGISTRATION REQUIREMENTS AND DEADLINES

13. Entry cards will be available at the show and, upon request, from the Horticulture Committee in advance of the show.
14. Entries eligible for the Elizabeth Platt Corning Medal and/or the Louise Agee Wrinkle Horticulture Propagation Award must have been in the possession of the exhibitor for at least six months (October 28, 2014) and will be identified by a check mark on the entry card. Plants grown using sustainable practices also will be identified by a check mark on the entry card.

#### ENTRY PROCESS

15. An entry card must include the name of the exhibitor, division, class, botanical and common names, length of ownership, propagation method and details of cultivation, if applicable. On a white 4" x 6" unlined "key" card, additional propagation information should be described. Entry card and propagation information must be written or printed in black waterproof medium.
16. Key cards (a plant list and diagram or 4" x 6" photograph with identifying marks) must be on white 4" x 6" unlined cards. Key cards are required in Classes 4, 33, 34–36, 40, 42, 48, 57 and 64, 66–67. The required information must be written or printed in black waterproof medium.
17. Each exhibitor is responsible for her own entry. Exceptions may be allowed only at the discretion of the Horticulture Committee.
18. Exhibitors must stay with their entry until it is passed and recorded in the Entry Book. Once an entry has been passed, it may not be touched by anyone other than the Placement Committee or Horticulture Chairmen.
19. The Placement Committee, Horticulture Chairmen and/or the Judges may subdivide classes and/or move or reclassify entries.

## JUDGING

20. Entries will be judged for horticultural achievement and conformance to schedule. For the scale of points for Horticulture, please refer to the GCA Flower Show and Judging Guide Chapter V, Section XII, or follow the link on our website, flohouston.org.

## REMOVAL

21. Wednesday, April 29, 2015, 6:15–7:00 p.m., all entries removed and horticulture cut specimens discarded.

## INQUIRIES

By e-mail at any time.

By telephone weekdays, 9:00 a.m.–5:00 p.m.  
Central Time.

### Tara Eastland

tgeastland@aol.com

713-960-8530

C: 281-639-9516

### Dodie Jackson

dodieojackson@gmail.com

713-528-5028

C: 713-299-2694



## Division II A: Horticulture

### *Verdant Reverie*

#### Classes

##### CUT SPECIMENS (CLASSES 1–36)

###### Classes 1–2. Perennials

###### Grown for flowers

1. Single stem

###### Grown for foliage

2. Single stem

###### Classes 3–4. Ferns

3. Single stem
4. Collection of three to five specimens of different species or cultivars. Each displayed in its own container (key card required).

###### Classes 5–9. Roses

###### One stem or spray with attached leaves

###### Stem in proportion to bloom size

5. Species
6. Old Garden Roses
7. Modern
8. Other
9. Rose (to be floated in a bowl provided by the Horticulture Committee, no stems or foliage required).

###### Classes 10–12. Bulbs, Corms, Rhizomes, and Tubers

###### One specimen with or without attached foliage

10. Bulb
11. Rhizome
12. Other

###### Classes 13–16. Annuals

###### Grown for flowers

13. Single stem
14. Three stems, same species or cultivar

###### Grown for foliage

15. Single stem
16. Three stems, same species or cultivar

###### Classes 17–20. Trees

###### Single branch

17. Flowering
18. Foliage
19. Berried/Fruiting
20. Other

###### Classes 21–24. Shrubs

###### Single branch

21. Flowering
22. Foliage
23. Berried/Fruiting
24. Other

###### Classes 25–28. Climbers and Vines

###### Single stem

25. Flowering
26. Foliage
27. Berried/Fruiting
28. Other

###### Classes 29–30. Edibles

29. Fruit (attached to stem)
30. Vegetable—Three-month ownership requirement (January 28, 2015).

###### Classes 31–33. Herbs

###### Six-month ownership requirement (October 28, 2014)

31. Single stem
32. Three stems of the same species in one container
33. Collection of three to five specimens of different species or cultivars. Each displayed in its own container (key card required).

###### Classes 34–36. Cut Collection

Cut materials from the exhibitor's garden arranged in a clear glass container provided by the exhibitor. The arrangement may not exceed 18" in any dimension; minimum of three species (key card required).

34. Flowering
35. Foliage
36. Combination of Flowering and Foliage

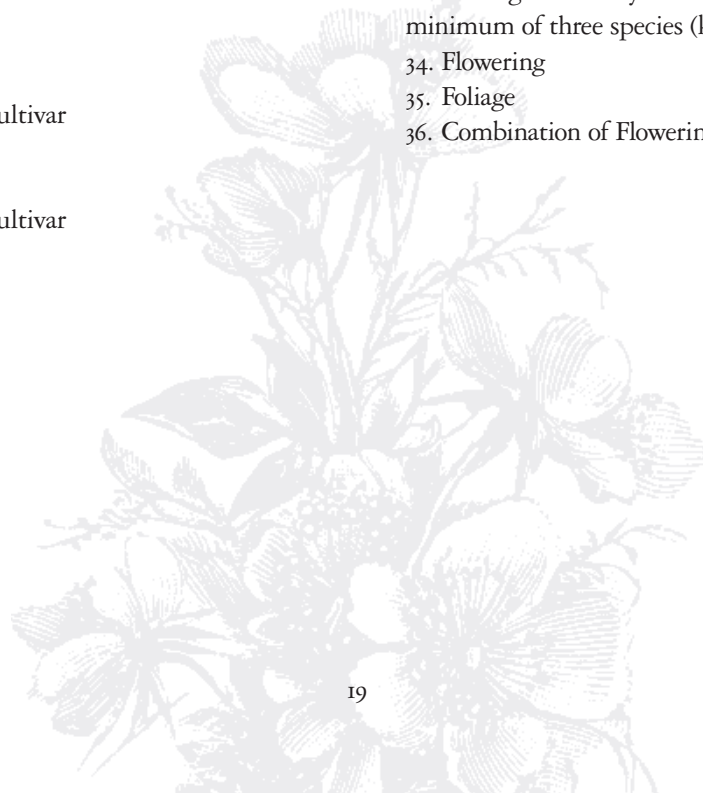

## CONTAINER-GROWN PLANTS (CLASSES 37–68)

### Classes 37–40. Trained Plants (Topiary)

Ownership requirement of nine months (July 28, 2014).

37. Trained in the Asian Manner (container requirement waived; no stands allowed).
38. Standard topiary: a single straight stem with the crown of growth at the top; topiary should stand straight without support.
39. Trimmed topiary: a specimen that is pruned into a stylized shape (no wire frame).
40. Trained topiary: one or more plants trained on two- or three-dimensional wire frame; key card required for more than one plant.

### Classes 41–42. Cacti

Ownership requirement of nine months (July 28, 2014).

41. One plant per container.
42. Three to five different species or cultivars per container (key card required).

### Classes 43–48. Succulents other than Cacti

Ownership requirement of nine months (July 28, 2014).

43. Agavaceae
44. Crassulaceae
45. Euphorbiaceae
46. Liliaceae
47. Other
48. Three to five different species or cultivars per container (key card required).

### Classes 49–52. Plants Grown Primarily for Flowers

One or more of the same species or cultivar; must be in bloom.

49. Begonias
50. Orchids—Ownership requirement of one year (April 28, 2014).
51. Roses
52. Other

### Classes 53–54. Plants Grown Primarily for Foliage

One or more plants of the same species or cultivar.

53. Variegated
54. Non-variegated

### Classes 55–56. Miniatures

A mature example of a plant which is naturally diminutive

55. Grown primarily for flowers.
56. Grown primarily for foliage.

### Class 57. Collections

Three to five plants grown in individual containers (key card required).

Ownership requirements for genus/species apply.

57. Three to five different species of the same genus.

### Classes 58–62. Propagation

Describe propagation process and dates on white 4" x 6" unlined card.

58. Single plant from a cutting.
59. Multiple plants of the same species or cultivar from cuttings.
60. Single plant from a seed.
61. Multiple plants of the same species or cultivar from seeds.
62. Single plant from other propagation method.

### Class 63. Pairs

Two plants of the same species or cultivar.

63. A matching pair of plants grown in individual containers.

### Class 64. Natural Containers

One or more plants grown in a natural container such as rock, stone or driftwood (container requirement waived).

Container may not exceed 18" in any dimension; key card required for more than one plant.

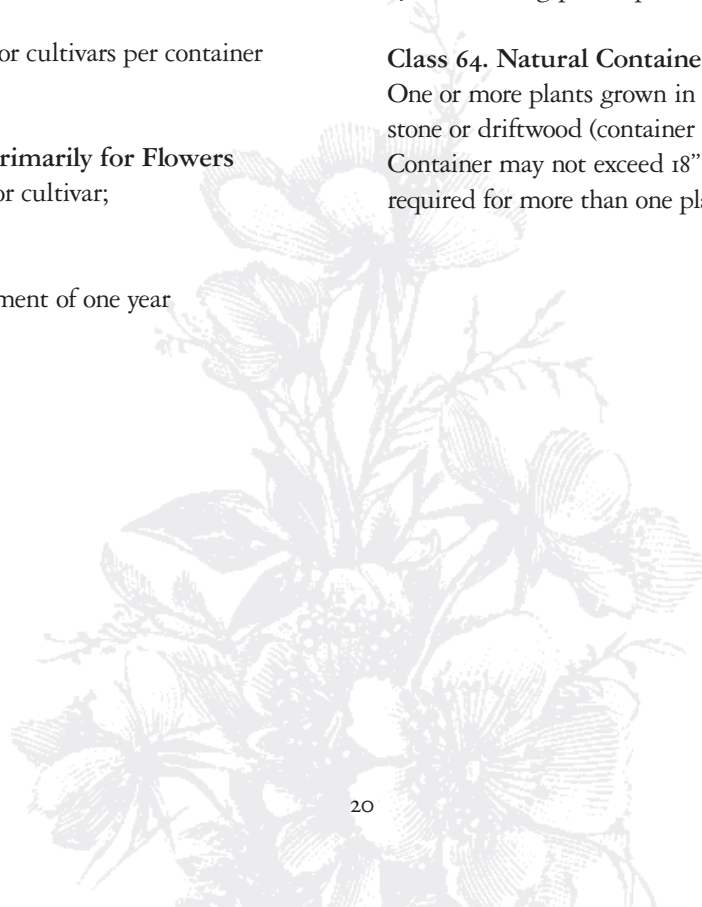

**Class 65. Lamar High School Challenge**

Open exclusively to Lamar High School students enrolled in LHS horticulture classes.

Containers and plants provided by the Horticulture Committee. Beginning to end written and photographic documentation of project is required.

65. Plants beneficial to butterflies, The Garden Club of America 2014 Freeman Medal Winner, Butterfly Weed, *Asclepias tuberosa*.

**Classes 66–67. Provisional Window Box Challenge**

Open exclusively to provisional members of River Oaks Garden Club (2nd year only) and The Garden Club of Houston. Displayed on a table top. Viewed from all sides (key card required).

Ownership requirement of six months (October 28, 2014).

Container and plants provided by the Horticulture Committee.

66. Window box of *Salvia* plants; variety to be determined.

67. Window box of *Salvia* plants; variety to be determined.

**Class 68. Par Class**

An exhibit of outstanding horticultural merit that does not qualify for entry elsewhere in the division (no cut specimens, bonsai, orchids, or hanging baskets).

Location: Beck Building, Second Floor Galleries.



## Division II B: Horticulture Design

### *Fantasia* Guidelines

1. Please carefully read and follow the GCA Rules and General Information and the Timetable for Exhibitors.
  2. Horticulture Design requires that live, rooted plant material be predominant in the design. No cut flowers are allowed in Classes 1 and 3.
  3. There is no ownership requirement.
  4. Plant material must be able to stay in show condition, with no watering or substitutions, for the duration of the show.
  5. Exhibits are not eligible for GCA Special Awards.
  6. A Best in Show for Division II B may be given, if merited.
  7. Judges' commendations may be given, if merited.
3. Plant list with common and botanical names along with optional brief statement of intent, 25 words or less, is due to the computer/entry chairman, Karen Ytterberg, [kytterberg@aol.com](mailto:kytterberg@aol.com), or Cynthia Lange, [cynthia.lange@me.com](mailto:cynthia.lange@me.com), by Wednesday, April 1, 2015, by using the entry form online at [flohouston.org](http://flohouston.org). Changes may be made at the show.
  4. There is a container fee of \$45.00 for Class 2, which must be paid at the time of online registration by credit card. If shipped, there will also be a shipping/handling fee.

#### ENTRY PROCESS

1. Entries must go through Division II Horticulture Plant Inspection prior to entering the museum. Plant Inspection is located in the Horticulture Entry area in the MFAH Parking Garage and Visitor Center (enter from Binz Street).
2. After clearing Plant Inspection, the entry is to be brought to the gallery where Horticulture Design is to be displayed. The entry will be passed in place.
3. A key card (diagram identifying plant material) is required for all classes on a 4" x 6" unlined white card, and must accompany the entry. The information must be written or printed in black waterproof medium. A 4" x 6" photograph with identifying marks may be used in lieu of a drawn diagram. Multiple cards may be used to complete all required information; please note the Division, Class, and Entry number on each card and use a paper clip to keep together.
4. The entry must be passed by a judge on the show floor before the exhibitor is allowed to leave. Passing includes review of the entry, completed key card(s), and exhibition form.

#### ENTRIES

1. Exhibitors must be members of GCA member clubs.
2. An exhibitor is permitted only one entry per class, but may enter more than one class. An exhibitor may have one partner per entry, both names are to be listed on the entry card.
3. Each entry must be the work of the exhibitor(s) under whose name(s) it has been registered. Only listed exhibitors and show personnel may be on the show floor at the time of entry.
4. If forced to withdraw, an exhibitor must notify the Registration Chairmen, Division Chairmen and find a substitute, unless there is a waitlist for the class.

#### REGISTRATION

1. Registration is online only, and is required between Monday, September 1, 2014, and Saturday, January 31, 2015, by registering online at [flohouston.org](http://flohouston.org). For any questions regarding registration, please contact one of the Registration Chairmen, Susan Doherty, [dohertysr@gmail.com](mailto:dohertysr@gmail.com), or Janet Lionberger, [janetlion@gmail.com](mailto:janetlion@gmail.com).
2. Registration is on a first-come, first-entered basis. A waitlist will be kept per class.

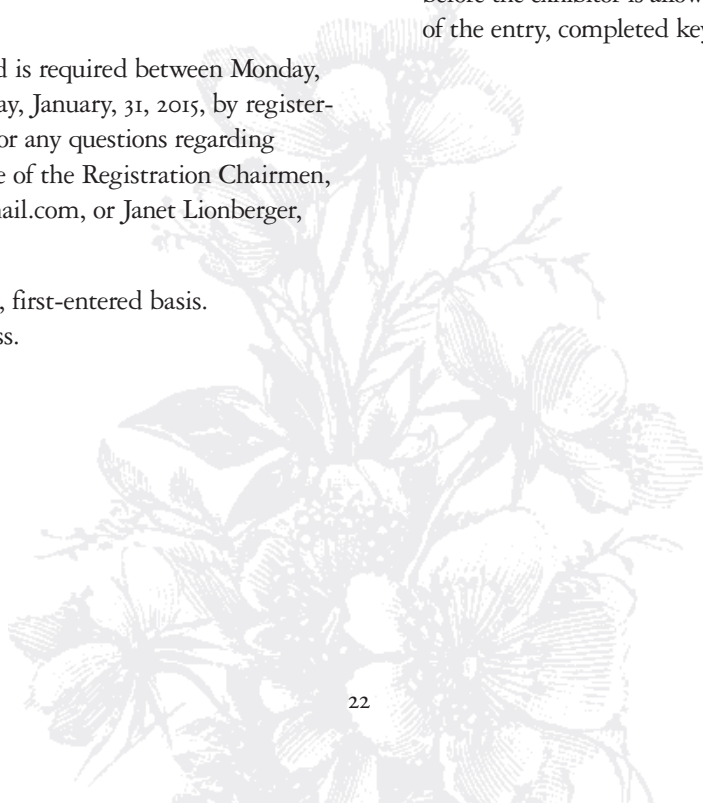



## JUDGING

1. Each exhibit will be judged for conformance to the flower show schedule.
2. Judges will consider compatibility and arrangement of plants and materials, attractiveness and originality, and appropriate size of plants for container.
3. Scale of Points

Cultural Perfection	55
Plant Variety	25
Creativity	15
Labeling	5
Total	<u>100</u>

## REMOVAL

1. All exhibits must be removed on Wednesday, April 29, 6:15–7:00 p.m. For an additional charge, an out-of-town exhibitor's entry may be returned by a shipping service. Please go to [flohouston.org](http://flohouston.org) for information.

## INQUIRIES

By e-mail at any time.

By telephone weekdays, 9:00 a.m.– 5:00 p.m.

Central Time

**Vaughan Clark**  
vaughanc1@aol.com  
713-899-8716

**Kingslea Von Helms**  
kt1648@aol.com  
713-899-2128



## Division II B: Horticulture Design

### *Fantasia*

#### Classes

##### **Class 1. *Fairyland***

**Up to 6 Entries**

A miniature design (scale: 1 inch = 1 foot) consisting of a combination of a minimum of three different naturally diminutive rooted species, varieties or cultivars, grown in soil or other medium, and other (optional) components in a natural container of the exhibitor's choice. Staged on a 36" x 12" square white pedestal. Container must be waterproof and must not exceed the size of the pedestal top. No cut flowers. Accessories are permitted. Key card required. A list of the plant material is required (Botanical name and Common name, if any). To be viewed from all sides.

##### **Class 2. *Magic Carpet Ride***

**Up to 6 Entries**

Pot-et-fleur: Create a design for this legendary mode of transportation with compatible rooted and fresh cut plant material. Staged on two 34" x 12" pedestals, as if carpet were flying. Fresh material needing water may be inserted in floral tubes, bottles, and/or floral foam, which must be hidden from view. Container may be embellished and must be waterproof. Accessories are not permitted. Key card required. A list of the plant material is required (Botanical name and Common name, if any). Viewed from all sides and above.

Rectangular, wood container, 2' x 3', to be supplied by the Horticulture Design Co-chairmen. Fee: \$45.

##### **Class 3. *Shangri-la***

**Up to 6 Entries**

Terrarium: Envision a paradise comprised of a minimum of three different rooted species, varieties, or cultivars in a container. Staged on a 36" x 12" square white pedestal. Be mindful of compatibility and arrangement of plants and materials, appropriate potting media, attractiveness and originality, and appropriate size of plants for container. A clear-glass, waterproof container with a top is to be of the exhibitor's choice and may not exceed the size of the pedestal top. No Wardian cases. No cut flowers. Accessories permitted. Key card required. A list of the plant material is required (Botanical name and Common name, if any). To be viewed from all sides.

Location: Beck Building, Gallery 208, Second Floor



# Division III

## *Imagined Images*

### Photography Guidelines

1. Please carefully read and follow the GCA Rules and General Information and Timetable for Exhibitors.
2. This is a Juried Show. The jury will choose six finalists in each class. An exhibitor may make only one entry in a class but may enter two classes. Advance registration is required between January 1, 2015 and January 31, 2015. Exhibitors will be notified if accepted or not, by February 25, 2015. Exhibitors will be notified if chosen as a finalist or not by February 25, 2015. The finalists will then print and mount the photograph and mail it to Fran Brennan by the March 25 deadline to be entered into the Florescence competition (see #13).
3. Photographs are to be submitted by uploading to flohouston.org in jpeg format, 1–5 megabytes, between January 1 and January 31, 2015. Each photographic file name should include the entrant's last name, first initial, zone, and class number, (e.g. Smith, J. IX–class 5.jpeg).  
  
You will be notified by e-mail that your registration and jpeg file have been received at the time of their submission. When registering your jpeg file on the website, you must hit “submit” to obtain a confirmation number. Please print the confirmation page for your record.  
  
\*Photography entry form may be found online at flohouston.org. Two copies are to be submitted with the finished photograph. One is to be attached to the back of the photograph and must include the exhibitor's name, garden club, zone, address, phone number and class entered. The top of the photograph must be indicated. Additionally, a duplicate loose copy of the entry form should be included (allowing the statement of intent and other information to be accessible after the entry is installed).
4. If forced to withdraw, an exhibitor must notify the division chairman, who will then invite the next highest ranked entry in that class.
5. Photographs that have won first place or a GCA special award in a GCA Flower Show, GCA Major Flower Show, or Sanctioned Non-GCA Major Flower Show may not be entered in competition again. A previously entered photograph that did not place first may be entered again if the image is significantly altered and newly printed. The same photograph may only be entered in one show at a time.
6. Each photograph must be the work of the exhibitor, under whose name it is registered. Matting, mounting, and printing may be done professionally.
7. Any manipulation at any stage must be the work of the exhibitor. This includes enhancement for color clarity, removal of part of the image, combining images, or distorting the original subject.
8. Photography entries are limited to subjects consistent with The Garden Club of America interests such as horticulture, floral design, gardens/landscapes, conservation, the environment, historic preservation, civic improvement, and the natural world. Plant material is not required.
9. Photographs must be mounted on foam core cut to the exact size of the image (flush mounting) with no over-matting. The size of the overall perimeter must be a minimum of 50” and not exceed 72”. The surface finish is the choice of the exhibitor. Glass, matting, and framing are not permitted.
10. The division chairman will provide a flower show entry card to be staged with each photograph. Identification of plant material on the entry card is not required, but is encouraged when possible.
11. An optional title or brief statement, not to exceed 25 words, may be included on the entry form and the entry card itself.
12. An exhibitor may not change classes after having submitted a jpeg.
13. Photographs must be received no later than March 25, 2015. Please mail your photograph to Fran Brennan, 2337 Tanglewood Road, Houston, TX 77005. Receipt of your photograph and entry forms will be acknowledged. For more information, contact Fran Brennan, mfranbrennan@aol.com, or 713-526-9206.

14. All photographs will be passed by the Photography Committee on March 27, 2015, to verify that class specifications have been met. If a photograph is not passed, the exhibitor will be notified and allowed, if time permits, to send a replacement photograph.
15. The Florescence Photography Committee may reclassify an entry, but only with the permission of the exhibitor.
16. The scale of points by which the classes are to be judged.

Creativity	25
Composition	25
Technical Skill	20
Conformance/Interpretation	20
Distinction	10
Total	<u>100</u>

#### REMOVAL

17. Photographs must be removed by museum staff and will be available for pick-up on Thursday for in-town exhibitors at a location to be announced. If a photograph is to be returned, the exhibitor must provide a self-addressed, prepaid label and packing material. Any award received will be noted on the back of the mount before it is returned. For an additional charge, an out-of-town exhibitor's entry may be returned by a shipping service. Please go to flohouston.org for information. If no return material is included, it will be assumed that the image will not be returned.

#### INQUIRIES

By e-mail at any time.

By telephone weekdays, 9:00 a.m.–5:00 p.m.

Central Time.

#### **Carol Junell**

carol@junell.cc

713-526-9206

#### **Fran Brennan**

mfanbrennan@aol.com

713-614-9093

#### **Anne Symmonds**

aasymmonds@gmail.com

713-305-4413

#### **Pat Gano**

patgano@hotmail.com

832-452-1020



Division III: Photography  
*Imagined Images*  
Classes

<b>Class 1. Reflections</b> Composition incorporating any reflective surface.	<b>Color</b>	<b>6 Entries</b>
<b>Class 2. Cloud Illusions</b> Composition of a dramatic cloud formation.	<b>Color</b>	<b>6 Entries</b>
<b>Class 3. Lilliputian's View</b> Composition featuring a macro shot of plant material. Novice only.	<b>Color</b>	<b>6 Entries</b>
<b>Class 4. Dreamscape</b> Landscape composition in impressionistic style utilizing creative techniques in which manipulation is obvious. Include 4" x 6" of original.	<b>Color</b>	<b>6 Entries</b>
<b>Class 5. Phantasmagorical</b> A color composition of an unexpected juxtaposition of elements, inanimate and natural.	<b>Color</b>	<b>6 Entries</b>
<b>Class 6. Atmospheric Alchemy</b> Composition featuring fog, smoke, mist, snow, or rain.	<b>Monochrome</b>	<b>6 Entries</b>
<b>Class 7. Evocative Garden</b> Composition of a garden that tells a story.	<b>Color</b>	<b>6 Entries</b>
<b>Class 8. Chiaroscuro</b> Study in light and shadow.	<b>Black &amp; White</b>	<b>6 Entries</b>
<b>Class 9. Conjuring Houston's Bayous</b> Composition capturing a sense of Houston's past, present, or future, incorporating one of Houston's seven bayous. Limited to River Oaks Garden Club and The Garden Club of Houston members.	<b>Color</b>	<b>6 Entries</b>

Location: Beck Building, Millennium Gallery, Lower Level, gallery height is 12'6"

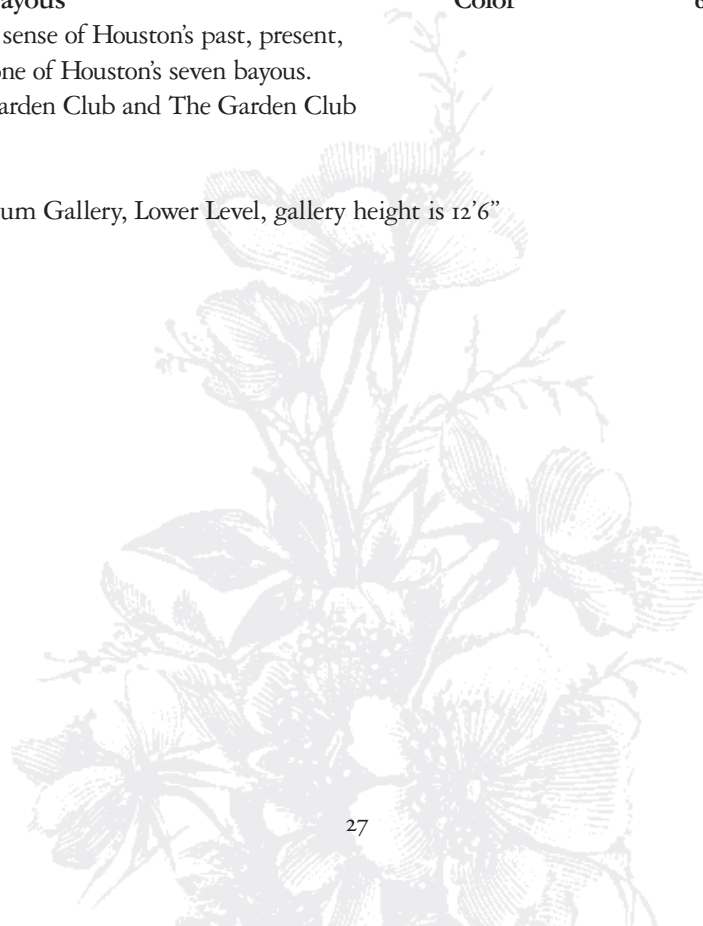

# Division IV A–C: Botanical Arts

## *Charmed* Guidelines

1. Please read carefully and follow the GCA Rules and General Information and Timetable for Exhibitors.

### ENTRIES

2. An exhibitor is permitted only one entry per class, but may enter more than one class. An exhibitor may have one partner per entry. Each exhibit must be the work of the exhibitor(s) under whose name(s) it has been registered.
3. If forced to withdraw, an exhibitor must find a substitute unless there is a waiting list for the class. The Division Chairmen must be notified immediately of any changes.
4. If a Botanical Arts entry has won first place or a GCA Special Award in a GCA Flower Show, a GCA Major Flower Show or Sanctioned Non-GCA Flower Show, it may not be entered in competition again. An exhibit which has been previously entered and did not place first may be entered again if the piece is significantly altered.
5. Mounts will be supplied to the entrant after registering.
6. Each entry must be the work of the exhibitor under whose name it is registered. All handiwork must be executed by the exhibitor.

### MATERIAL REQUIREMENTS

7. All plant material must be dried. This includes flowers, foliage, seeds, pods, nuts (in or out of shells), vegetables, twigs, vines, reeds, etc. Only plant material, mechanics, and their surface treatments (i.e. paints, nail polishes, varnishes, and waxes, etc.) are permitted. Artificial, endangered, and locally invasive plant material may not be used.
8. Figural forms must be assembled or judiciously carved by the exhibitor. Any plant material may be cut, incised, or shaped to enhance artistic effect.
9. Non-plant material (i.e. cardboard, metal, twine, string, cording) may be used only for construction and must not show.
10. Processed products may not be included in design (e.g., couscous, tapioca, balsa wood).
11. Division IV C, Botanical couture, entries must be created from all dried plant material.

### REGISTRATION INFORMATION AND DEADLINES

12. Registration is online only and is required between Monday, September 1, 2014, and Saturday, January 31, 2015, by registering online at [flohouston.org](http://flohouston.org). For any questions, please contact one of the Division Chairmen.

### ENTRY PROCESS

13. A sample card must accompany each entry. An untreated sample of each plant material used in the design, correctly identified with botanical and common names, affixed to a 4" x 6" unlined white card.
14. Entries must be received by Monday, April 6, 2015. Exhibitors may ship or deliver entry/entries and required sample key card to Francey Pengra, 3315 Ferndale Street, Houston, Texas 77098. The entries will be considered for passing as they are unpacked.
15. Exhibitors absent from the show may indicate in writing another individual authorized to make repairs to exhibitor's entry. Contact information must be provided.
16. The Botanical Arts Committee will be responsible for the installation of the exhibits. Each exhibit will be handled with the utmost care. Indicate in writing, and include with exhibit, any special instructions for display.

### JUDGING

17. Scale of points by which the classes are to be judged:

Design	35
Craftsmanship	30
Originality	15
Interpretation of Theme	10
Distinction	10
Total	<hr/> 100

### REMOVAL

18. Wednesday, April 29, 6:15–7:00 p.m., all entries removed. For an additional charge, an out-of-town exhibitor's entry may be returned by a shipping service. Please go to [flohouston.org](http://flohouston.org) for information.

### INQUIRIES

By e-mail at any time.  
By telephone weekdays, 9:00 a.m.–5:00 p.m.  
Central Time.

Lynn Wilson  
[lmw2710@yahoo.com](mailto:lmw2710@yahoo.com)  
713-478-4114

Francey Pengra  
[fpengra@earthlink.net](mailto:fpengra@earthlink.net)  
713-248-8822

## Division IV A–C: Botanical Arts

### *Charmed*

### Classes

#### SECTION A. BOTANICAL JEWELRY

##### Class 1. Flights of Fancy

Up to 6 Entries

Create a brooch depicting a winged creature displayed on a black velvet mount. Entry must not exceed the size of the mount. Viewed from all sides and above.

##### Class 2. Jewels du Jour

Up to 6 Entries

Create a pair of ear clips displayed on a black velvet mount. Entry must not exceed the size of the mount. Viewed from all sides and above.

#### SECTION B. BOTANICAL EMBELLISHMENT

##### Class 3. Minaudiere

Up to 6 Entries

Embellish a supplied small wooden purse displayed on a black velvet mount. Entry must not exceed the size of the mount. Viewed from all sides and above.

*Minaudiere*—A woman's fashion accessory generally considered a jewelry piece, intended to substitute for an evening bag

#### SECTION C. BOTANICAL COUTURE

##### Class 4. Fairy Fashionable

Up to 6 Entries

Using an array of natural elements create a fairy/fantasy couture gown on a miniature dress form supplied by the committee. Viewed from 3 sides.

Location: Beck Building, Gallery 227, Second Floor



Division IV-D: Needle Arts  
“Sleight of Hand”  
Guidelines

1. Please carefully read and follow the GCA Rules and General Information and Timetable for Exhibitors.

**ENTRIES**

2. An exhibitor is permitted only one entry per class, but may enter more than one class with permission from the Division Chairmen. Each exhibit must be the work of the exhibitor under whose name it has been entered.
3. If forced to withdraw, an exhibitor must find a substitute unless there is a waiting list for the class. The Division Chairmen must be notified immediately of any changes.

**MATERIAL REQUIREMENTS**

4. There are no thread requirements. Beading is allowed.
5. All canvases will be finished in the same style by the Needle Arts Committee.
6. Consultants may be used for the design of the stitches.

**REGISTRATION REQUIREMENTS AND DEADLINES**

7. Registration is online only and is required between Friday, August 1, 2014, and Saturday, November 1, 2014, by going online at flohouston.org. For registration questions, please contact the Registration Chairmen, Susan Doherty, dohertysr@gmail.com, or Janet Lionberger, janetlion@gmail.com.
8. Class entry fee is \$125 and must be paid at time of registration. Entry fee includes canvas and finishing, but does not include threads that must be selected and purchased by exhibitor.
9. Canvases will be distributed upon receipt of registration and entry fee.

**ENTRY PROCESS**

10. Exhibitors may ship or deliver entry/entries to Betsy Garibaldi, 3721 Piping Rock Lane, Houston, Texas 77027. Entries must be received no later than Monday, February 2, 2015.
11. The Needle Arts Committee will be responsible for the installation of the exhibit.

**JUDGING**

12. Scale of points

Overall stitching design	25
Color	25
Technique	25
Suitability of materials	25
	<hr/>
	100

**REMOVAL**

13. Wednesday, April 29, 6:15–7:00 p.m., all entries removed. For an additional fee, an out-of-town exhibitor’s entry may be returned by a shipping service. Please go to flohouston.org for information.

**INQUIRIES**

By e-mail at any time.  
By telephone weekdays between 9:00 a.m. and 5:00 p.m. Central Time.

**Betsy Garibaldi**  
Betsy.garibaldi@gmail.com  
713-927-4666

**Anne Hawkins**  
aehawkmath@aol.com  
713-253-6339

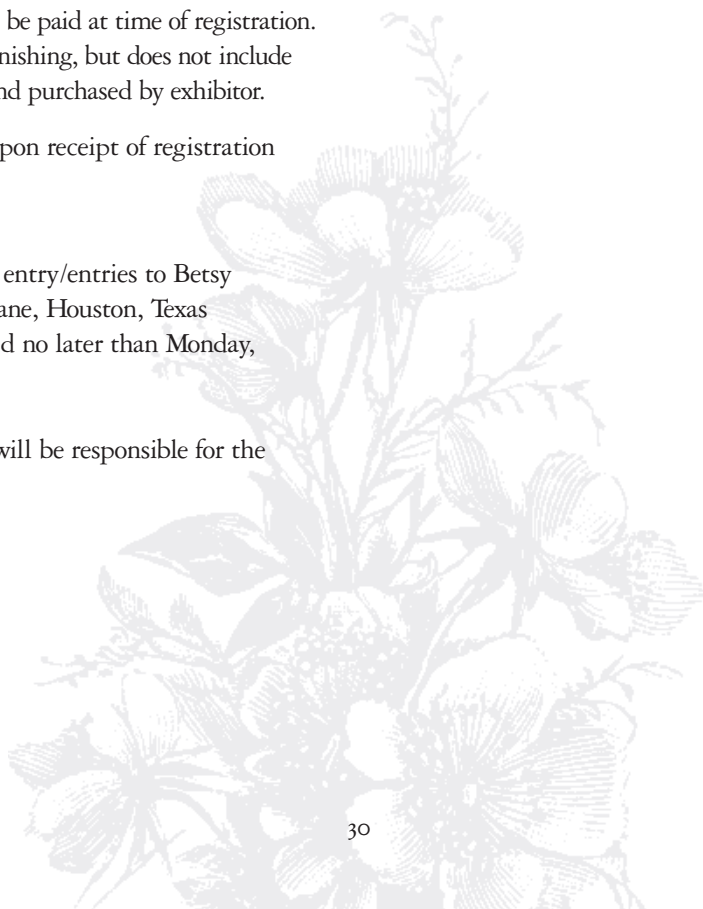



## Division IV-D: Needle Arts

### *“Sleight of Hand”*

#### Classes

##### SECTION D. BOTANICAL ARTS – NEEDLEWORK

###### Class 5. TROMPE L’OEIL

Up to 6 Entries

A visual illusion designed by the exhibitor with own fibers for a finished size of 5” x 7” on an 18” mesh canvas mounted inside a wooden frame. Canvas and finishing provided by the committee. Viewed standing from the front.

The book *Trompe L’Oeil Bible* by Christopher Westall will be provided by the Division Chairmen.

###### Class 6. KALEIDOSCOPE

Up to 6 Entries

An ornament of intricate patterns mimicking mirrors and colorful bits of glass designed and stitched by the exhibitor with own fibers and embellishments on a provided 4” x 4” mesh painted canvas. A minimum of one reflective material must be used in each entry. Finishing provided by the committee. Viewed from the front.

###### Class 7. MAD HATTER’S TEA PARTY

Up to 6 Entries

Hand painted canvas of 3-D teacup and saucer provided by the committee and stitched by the exhibitor with own fibers and embellishments. Finishing provided by the committee. Viewed from all sides.

Location: Beck Building, Gallery 201, Second Floor



## Division V: Conservation

### *In Praise of Pollinators: Unlocking the Magic and Mystery*

Pollination is the movement of pollen, which contains the male genetic material, from one flower to another of the same species. Without this transfer, the production of seeds and fruits would be impossible. For most of us, honeybees come to mind when we think about pollination. In fact, many of these honeybees are imported—European in origin, and they are vital to the pollination of much of our commercial fruit and vegetable crops. However, these honeybees are but one of a number of important pollinators. Other important pollinators are native bees, wasps, butterflies, birds, bats, beetles, and even flies! These creatures are vital for the pollination of flowering plants in other just as important areas—prairies, home gardens, urban landscapes, wildflower fields, forested areas, along our roads and highways, and anywhere flowering plant life is growing. In fact, more than 75% of all flowering plants depend on pollinators such as these. It has been estimated that one in three bites that we put into our mouths contain foods that require pollination. And, pollinators are necessary for the reproduction of more than two-thirds of the flowering plants and fruits and vegetables growing around the world.

The good news is that there are nearly 3,500 species of native bees and other pollinators in the United States that provide an enormous contribution to the things we eat and enjoy seeing and smelling in the garden. The bad news is that according to many experts, pollinators around the world are in serious trouble as habitat loss, disease, parasites, pesticides, invasive competition, changing climate, and more are threatening them. But there is much we can do to help them.

This exhibit is designed to increase awareness and appreciation of the importance of pollinators to plants and to the web of life and demonstrate:

- who our pollinators are and why it is important to protect them
- the factors that are putting pollinators at risk
- what we can do to improve conditions for today's pollinators

River Oaks Garden Club and The Garden Club of Houston created this exhibit, along with our community partner, Urban Harvest. Urban Harvest promotes healthy communities, sound nutrition, and respect for the environment by educating children and adults and facilitating harvest and habitat gardens. There are plans for this exhibit to be used in schools, nature centers, and at other related future events throughout the Houston area.

Location: Beck Building, First Floor Lobby

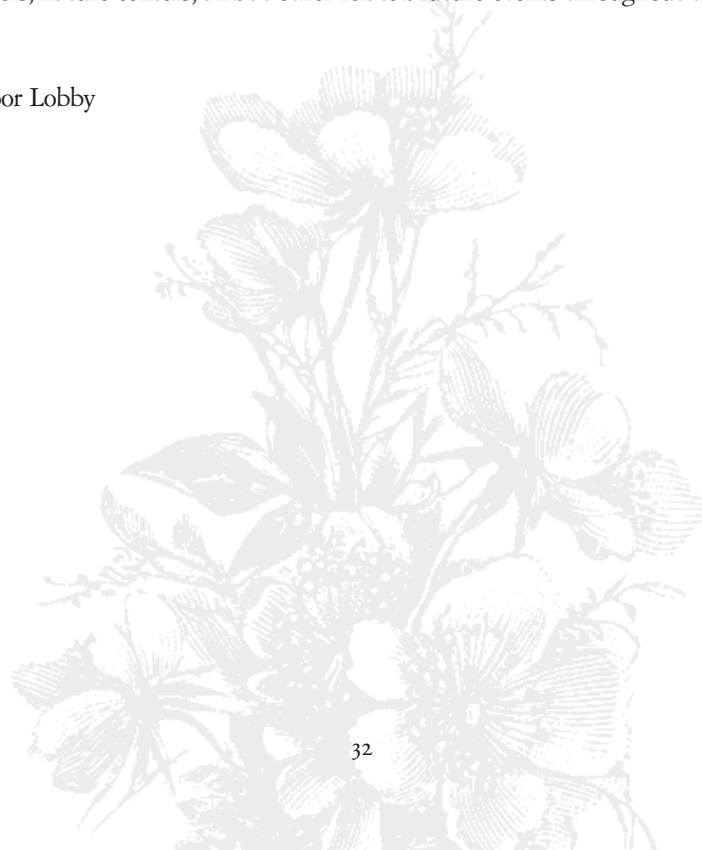

Division VI: Art by Invitation  
*Fantasy Friends*  
Classes

**Class 1. *Lamar High School FFA***

**Up to 4 Entries**

Floral designs created by members of the Lamar High School FFA club staged on a 36" x 12" square pedestal not to exceed 18" from center of pedestal and 6' in overall height from floor. Gallery height is 12'6"; gallery wall color is Benjamin Moore White. Viewed from three sides.

Location: Beck Building, Millennium Gallery, Lower Level

**Class 2. *Texas State Floral Association***

**Up to 4 Entries**

Floral designs created by members of the Texas State Floral Association staged on a 41" high x 13" round pedestal not to exceed 18" from center of pedestal and 8' in overall height from floor. Gallery wall color is cast stone. Viewed from three sides.

Location: Beck Building, Glassell Sculpture Court, Gallery 110, First Floor

**Class 3. *The Asia Society Texas***

**Up to 4 Entries**

Floral designs created by members of the Asia Society Texas staged on a 40" x 14" square pedestal not to exceed 18" from center of pedestal and 8' in overall height from floor. Gallery height is 15'; gallery wall color is a custom mixed beige. Viewed from three sides.

Location: Beck Building, Gallery 203, Second Floor

**Class 4. *Ikebana International, Houston Chapter***

**Up to 4 Entries**

Floral designs created by members of Ikebana International, Houston Chapter, staged on a 40" x 14" square pedestal not to exceed 18" from center of pedestal and no height restrictions. Gallery wall color is custom-mixed white. Viewed from three sides.

Location: Beck Building, Jamail Atrium, Gallery 200, Second Floor

**INQUIRIES**

By e-mail at any time.

By telephone weekdays, 9:00 a.m.–5:00 p.m.

Central Time.

**Mary Jane Wakefield**

Mjw715@aol.com

713-526-2228

**Betsy Griffin**

bgriffin@griffinpartners.com

713-622-3588

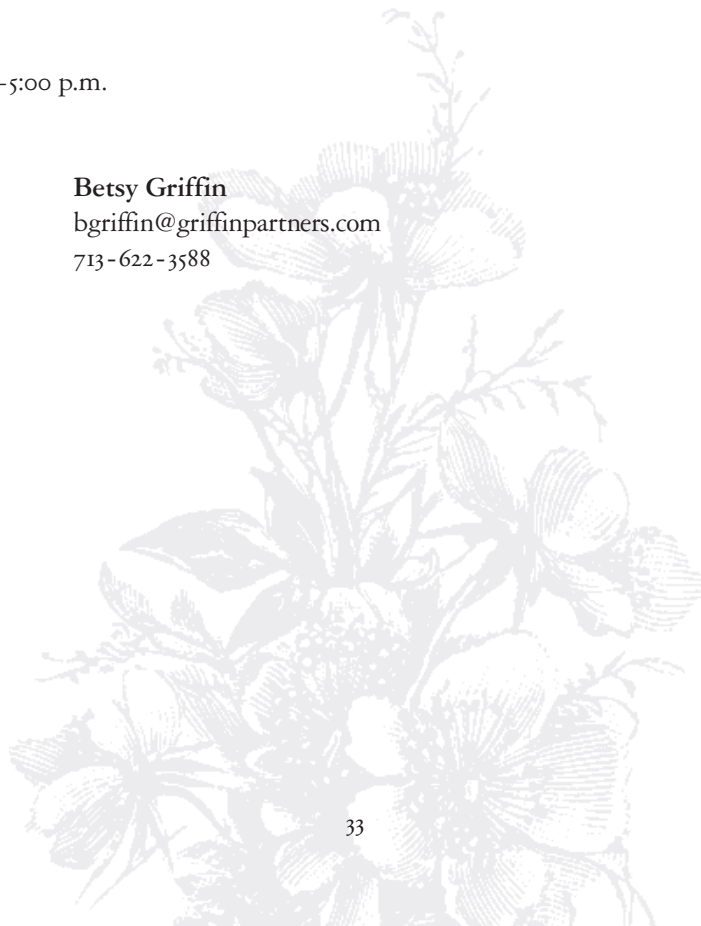

# GCA MAJOR FLOWER SHOW AWARDS

GCA Major Flower Show Awards described below have been applied for and will be presented if merited.

## *Division I, Floral Design*

The **Carol Coffey Swift Medal of Excellence** may be awarded to members of GCA clubs. It is offered in recognition of an arrangement of great distinction in a competitive class at a GCA Major Flower Show. Either an individual or joint entries are eligible. The entry must have placed first, second, or third. An entry in any challenge class is not eligible to receive this award.

The **Fenwick Medal** may be awarded to members of GCA clubs in competitive floral design classes at a GCA Major Flower Show. It is offered in recognition of creative work of outstanding beauty using predominantly fresh plant material. The awarding of the Fenwick Medal lies in the clear interpretation by the judges of the intent of the medal. A standard of creativity and quality in a highly competitive show rather than Best in Show is required. The design must have placed first, second, or third. An entry in a challenge class is not eligible to receive this award.

The **Margaret Clover Symonds Medal** may be awarded to members of GCA clubs in a competitive floral design class at a GCA Major Flower Show. The design must be an innovative, modern design, creatively combining man-made material(s) with fresh and/or dried plant material (as the schedule permits). Either individual or joint entries are eligible. The entry must have placed first, second, or third. An entry in a challenge class is not eligible to receive this award.

The **Sandra Baylor Novice Award** may be given at a GCA Major Flower Show to an exhibitor who is a member of a GCA club and who has never won first place or a GCA Special Award in the Floral Design Division of a GCA Major Flower Show or Sanctioned Non-GCA Major Flower Show. It shall be awarded to an individual novice exhibitor for a unique and skillful response to the schedule. Novice entries placing first, second, or third in any competitive class, including challenge classes, are eligible for this award.

## *Division II, Horticulture*

The **Certificate of Excellence in Horticulture** may be awarded at a GCA Major Flower Show to GCA clubs or club members, nonmembers, or other organizations for an exhibit of great distinction in a competitive horticulture class. The entry must have placed first, second, or third.

The **Elizabeth Platt Corning Medal** may be awarded only to members of GCA clubs only in a competitive horticulture class in a GCA Major Flower Show. The medal is to be awarded to an entry presented with distinction and originality notable for its cultural difficulty. It must have achieved an exceptional standard of horticultural excellence. Extra consideration will be given to an entry propagated by the exhibitor; full propagation details must be listed on a card accompanying the entry. The exhibitor must have owned and grown the exhibit for at least six months. The medal may be awarded for a single plant, collection of plants, container garden, or cut specimen(s). Individual, joint, or club entries are eligible. The entry must have placed first, second, or third. The medal may not be awarded more than once to the same exhibit.

The **Louise Agee Wrinkle Horticulture Propagation Award** may be awarded at a GCA Major Flower Show to a GCA member for skill in plant propagation. The exhibit must have been propagated and grown by its exhibitor for at least six months and should be distinguished by its prime condition, cultural perfection, attractive presentation, and flawless grooming. It is for rooted plants propagated by seed, cuttings, or other traditional methods. It can be a single specimen, source plant and its offspring, or a collection. Propagation methods must be detailed on an accompanying card. The medal may not be awarded more than once to the same exhibit.

## *Division III, Photography*

The **Certificate of Excellence in Photography** may be awarded at a GCA Major Flower Show to GCA clubs, individual club member, individual nonmember, or other organizations for an exhibit of great distinction in a competitive photography class. The entry must have placed first, second, or third.

The **Photography Creativity Award** may be awarded at a GCA Major Flower Show to an exhibitor who is a member of a GCA club for creative and technical excellence in response to the theme of the schedule. The entry must have placed first, second, or third.

### *Division IV, Botanical Arts*

The **Botanical Arts Creativity Award** may be awarded at a GCA Major Flower Show to a member of a GCA club for excellent craftsmanship and creative response to the theme of the schedule. The entry must have placed first, second, or third.

### *Divisions II, III, IV*

The **GCA Novice Award** may be given at a GCA Major Flower Show in **Horticulture, Photography, and Botanical Arts** to an exhibitor who is a member of a GCA club and who has never won first place or a GCA Special Award in the division entered, of a GCA Major Flower Show, or a Sanctioned Non-GCA Major Flower Show. It shall be awarded to an individual novice exhibitor for an outstanding exhibit. Novice entries placing first, second, or third are eligible for this award.

### *Division V, Conservation and Education Exhibits*

The **Ann Lyon Crammond Award** may be presented at a GCA Major Flower Show to an outstanding educational exhibit which best educates the public about gardens. Any educational exhibit that increases the appreciation of any aspect of plants, gardens, or landscape design may be considered for this award. The award may be given to GCA club members, member clubs, nonmembers, or other organizations.

The **Certificate of Excellence in Conservation** may be awarded at a GCA Major Flower Show to GCA clubs or club members, nonmembers, or other organizations for an exhibit of exceptional merit which educates the public on conservation issues and promotes respect for natural resources and responsibility for environmental stewardship.

### *Overall*

**Best in Show**, selected from among the first place winners, may be awarded in each division.

### **Horticulture Best Cut Specimen**

**Judges' Commendation** may be given to an entry, class, section, special exhibit, or other aspect of the show that is of exceptional merit.

**Award of Appreciation** may be given to thank an exhibitor or group for participation. The award may also be given to non-judged classes.

The **Annie Burr Jennings Sweepstakes Award** may be presented to the club with the highest number of points earned by its members from all competitive classes in a GCA Major Flower Show. Points are to be awarded as follows:

Special award*	10 points
1st place	5 points
2nd place	3 points
3rd place	1 point

\*(For each award listed in the schedule)

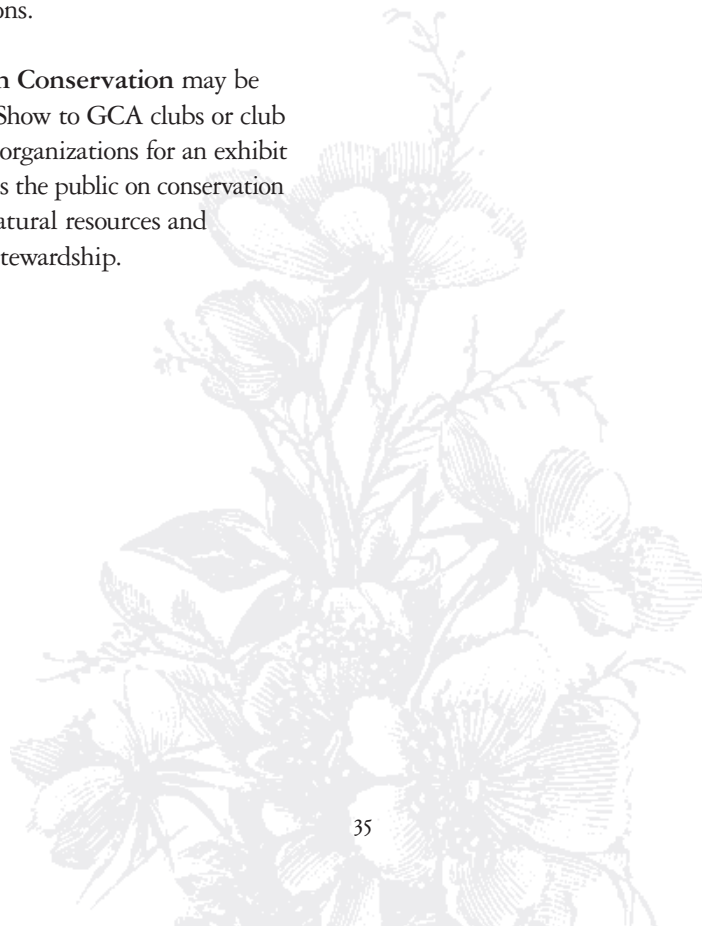

# Campus Map

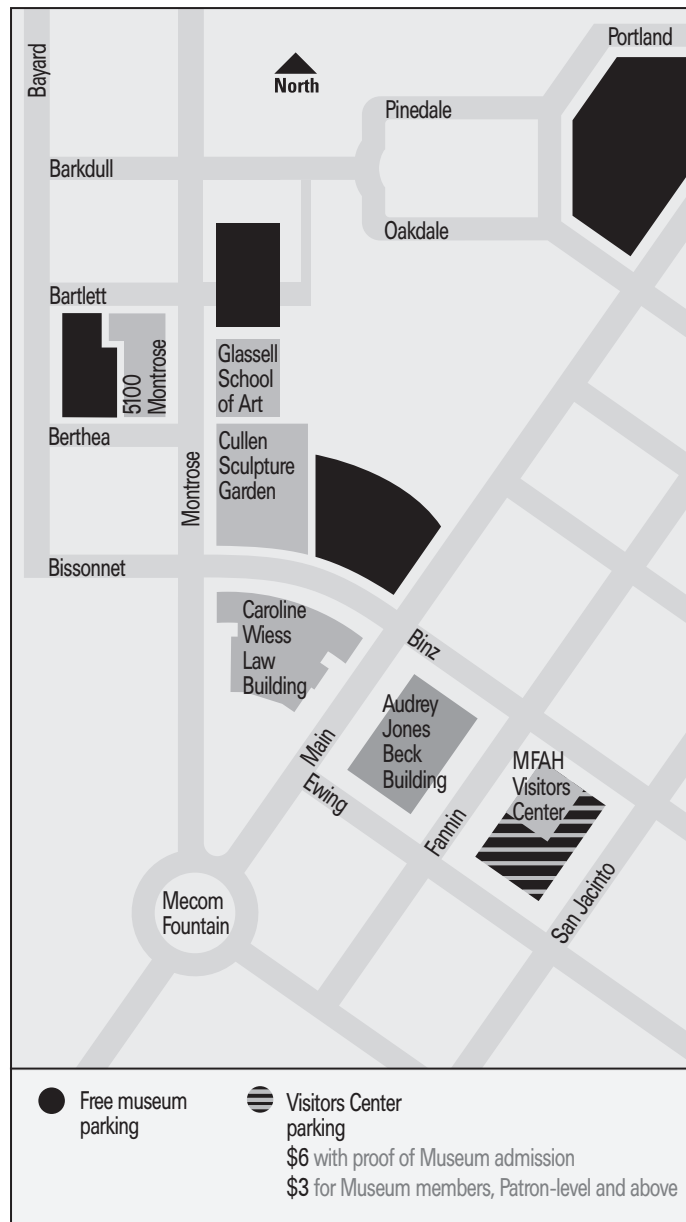

## The Museum of Fine Arts, Houston

713-639-7300

## The Caroline Wiess Law Building

1001 Bissonnet

## The Audrey Jones Beck Building

5601 Main Street

# Beck Building

## Lower Level

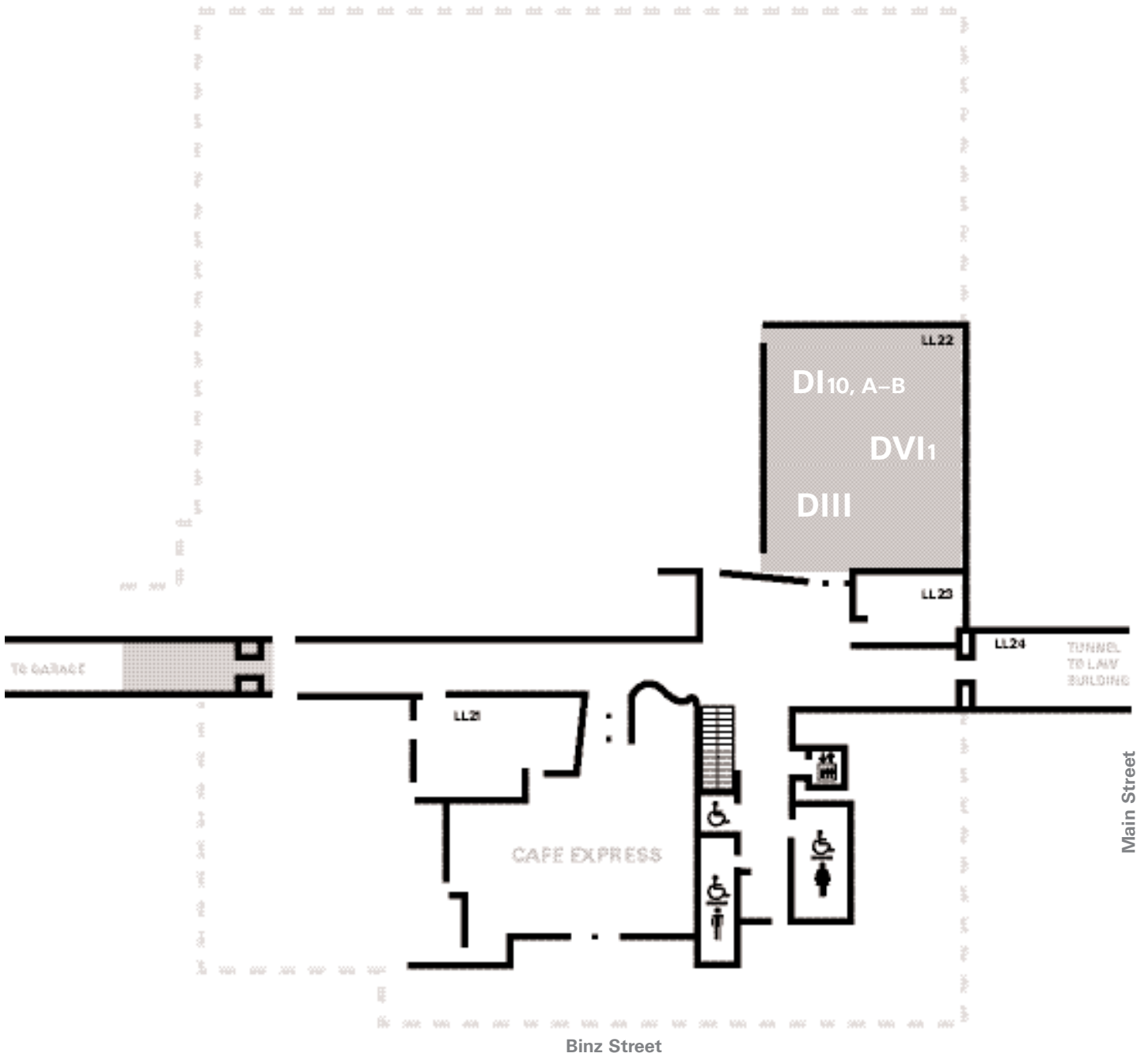

- DI10** Floral Design (Class 10, A-B)
- DIII** Photography (Classes 1-9)
- DVI1** Art by Invitation (Class 1)

**Beck Building**  
First Floor

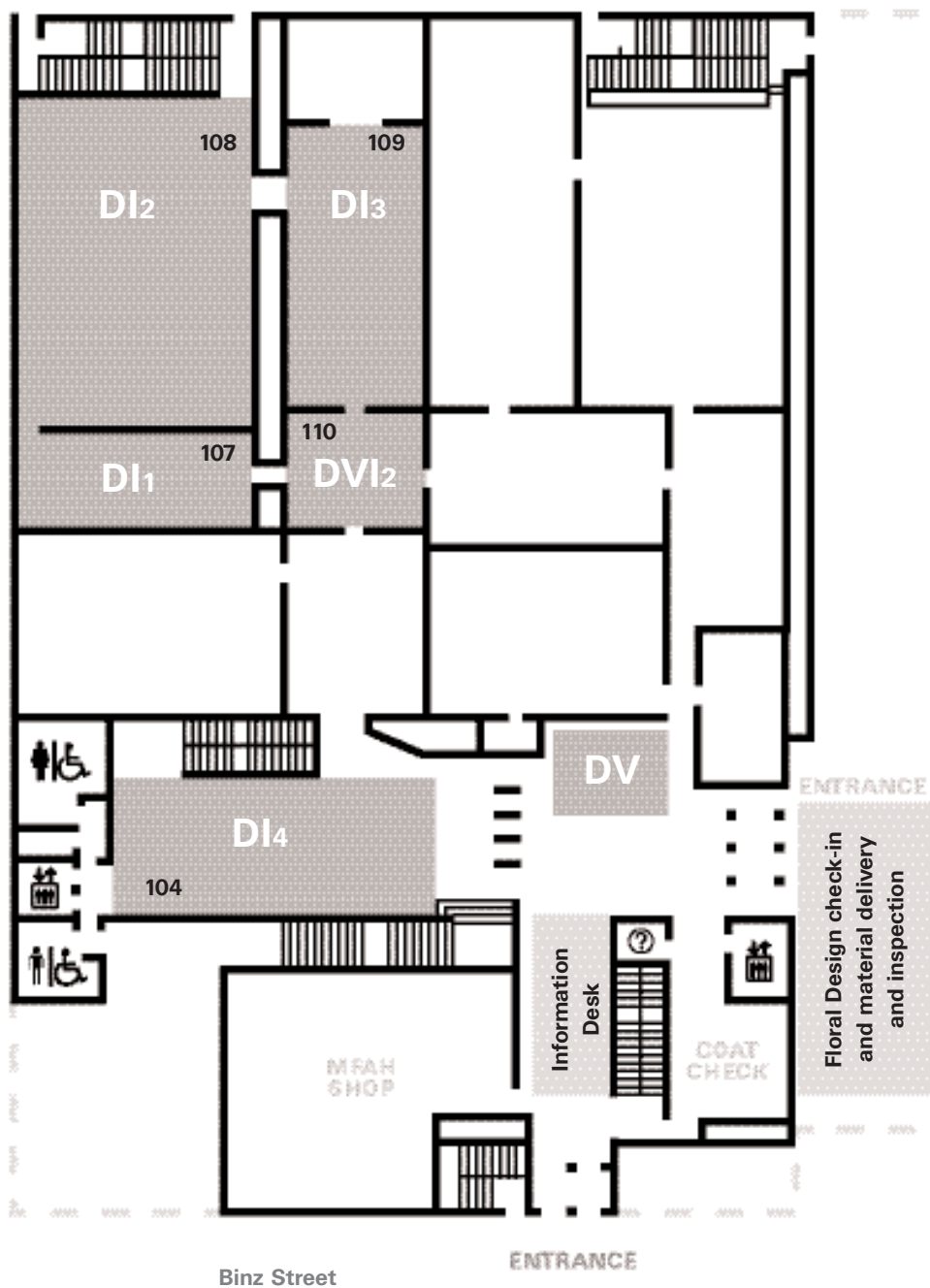

Main Street (Porte Cochere)

- DI1** Floral Design (Class 1)
- DI2** Floral Design (Class 2)
- DI3** Floral Design (Class 3)
- DI4** Floral Design (Class 4)
- DV** Conservation
- DVI2** Art by Invitation (Class 2)



**Beck Building**  
Second Floor

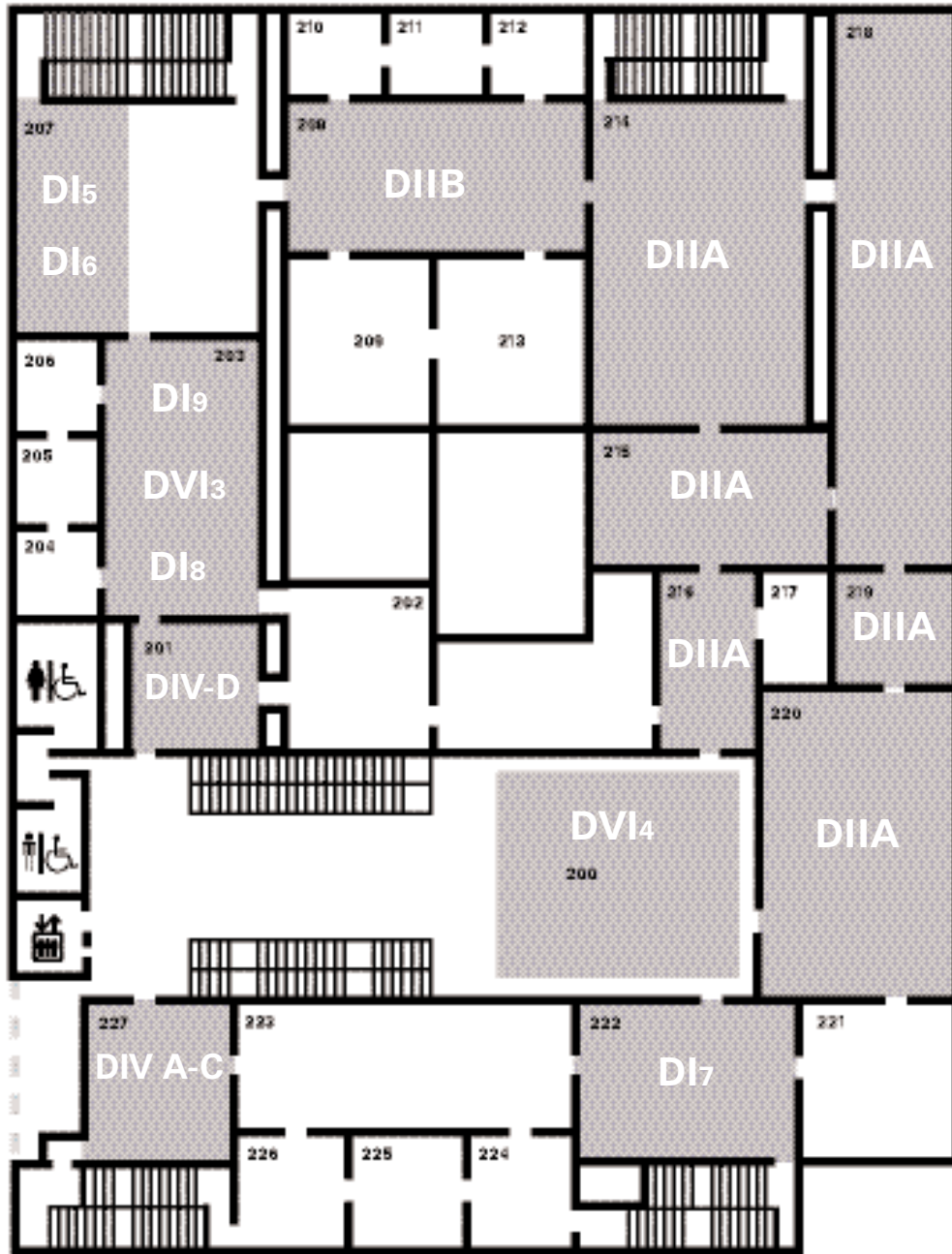

- DI5** Floral Design (Class 5)
- DI6** Floral Design (Class 6)
- DI7** Floral Design (Class 7)
- DI8** Floral Design (Class 8)
- DI9** Floral Design (Class 9)

- DIIB** Horticulture Design
- DIV A-C** Botanical Arts
- DIV D** Needle Arts
- DVI3** Art by Invitation (Class 3)
- DVI4** Art by Invitation (Class 4)







RIVER OAKS GARDEN CLUB  
THE GARDEN CLUB OF HOUSTON  
THE MUSEUM OF FINE ARTS, HOUSTON

[flohouston.org](http://flohouston.org)